



advanced FLOW engineering™
 P.O. Box 1719
 Corona, CA 92878
 Support: 951-493-7100
 aFepower.com

Intake Kit Installation Instructions: Ford F250/350/450/550/Excursion 1999.5-2003 V8-7.3L (td) Stage 2

Kit P/N:	51-10062 (ProDry S media only)		
	54-10062 (Pro5R media only)		
	75-10062 (ProGUARD 7 media only)		
	75-10062-0V (ProGUARD 7 and ProDryS)		
	54-10199 Torque Booster Tube		
Make:	Ford		
Model:	Year:	Engine:	
F-250	'99.5-'03	V8-7.3L (td)	
F-350	'99.5-'03	V8-7.3L (td)	
F-450	'00-'03	V8-7.3L (td)	
F-550	'01-'03	V8-7.3L (td)	
Excursion	'00-'03	V8-7.3L (td)	

Tools Required:
5/16" nut driver
Flat head screwdriver
Phillips screwdriver

Parts List:		
1 Air filter : Pro 5R™ 24-40035	1 1/2" hose @ 1.5"L	
Pro-GUARD 7™ 72-40035	1 3/4 trim seal @ 28.5"L	
Pro Dry S™ 21-40035	1 3/4 trim seal @ 6.5"L	
1 Housing		
1 Splash Guard		
1 Tube, (05-00628)		
2 Coupler, Straight (05-00441)		
4 Clamp, #064		
4 Screws, #8-32		
1 Mini clamp #006		

Included in P/N 75-10062-0V Value Pack Only:

- 1 Spare Filter P/N 21-40035
- 1 Pre-filter P/N 28-10011
- 1 Cleaning Kit 90-50500



Complete kit components

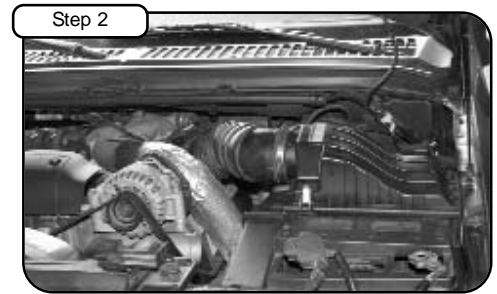

Complete Stock Intake.
 Disconnect battery before install.

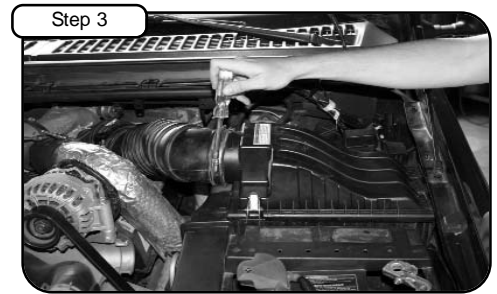

Remove the upper portion of the air box by loosening the hose clamp on the air box. Carefully remove the air filter minder on the side of the air box.

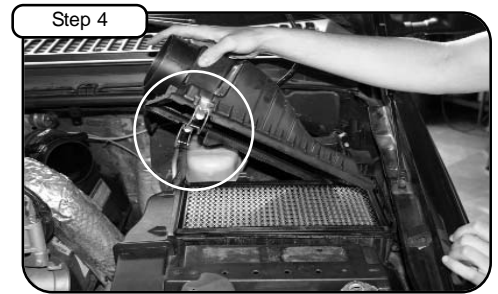

Loosen the air box lid clamps and remove air box lid and OEM air filter.

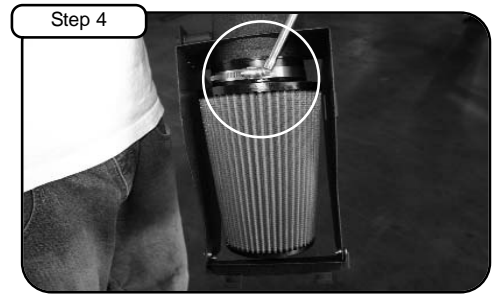

Place the new air filter inside the new housing and tighten the clamp. Next attach the front splash guard to the front of the housing. Secure with the provided screws.

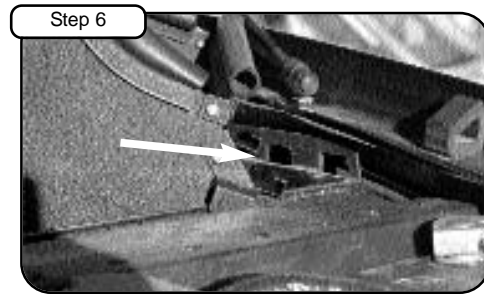

Take kit and insert taps of splash panel into slots on the lower half of OE housing at an angle. (Tabs are to be inserted into and rest on the bottom edge of slots. Do not hook tabs over plastic.

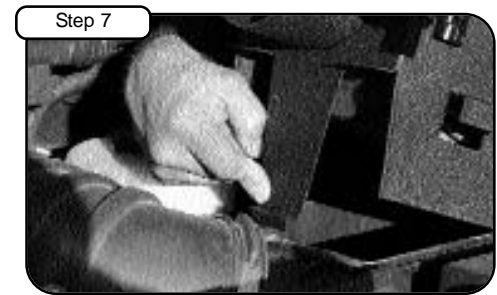

Depress spring tab slightly and lower the filter housing down into OE housing until the spring tab snaps into place.

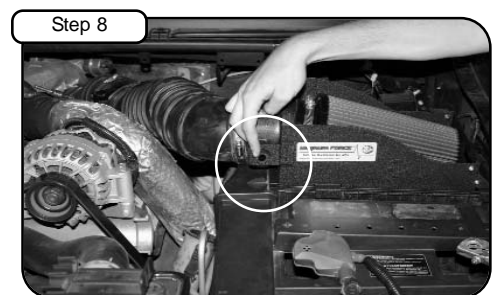

Insert the 1.5" hose into the nipple on the side of the housing. The filter minder will be placed here.

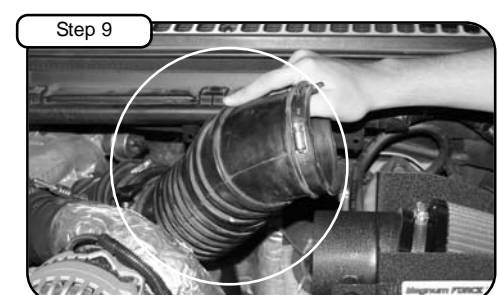

Loosen the hose clamps on turbo side. Remove intake duct out of the engine bay. Follow Steps 9-13 to install the Torque Booster Tube P/N 54-10199.

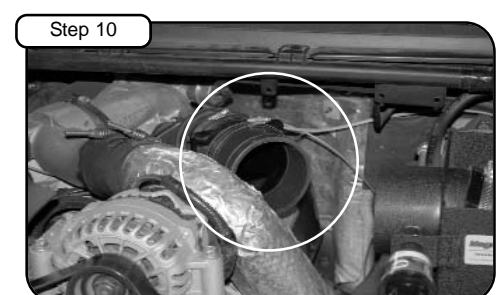

Place the coupler and clamps over the turbo inlet. Do not tighten the clamps at this time.

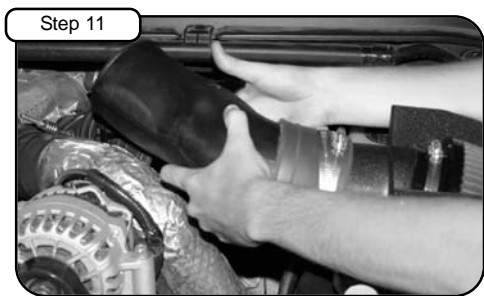

Slide coupler and clamps on tube. Position assembly into the intake kit.

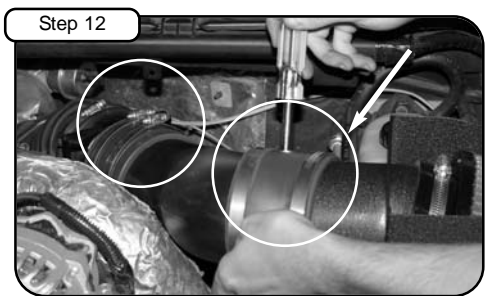

Tighten all the clamps using 5/16" nut driver. Do not overtighten. Attach trim seal to housing. Reconnect battery terminals.

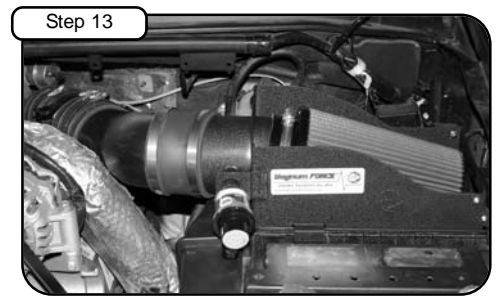

Your aFe intake installation is now complete. Make sure all clamps are tight and that all electrical components are secure. Check and tighten connections after a few hours of operation. Thank you for choosing aFepower!

Place enclosed CARB EO sticker on a clean/smooth surface on or near the intake system. EO identification label is required in passing the Smog Check inspection.

Note: Filter Cleaning and Re-oiling: When cleaning your aFe filter, be sure to use only aFe's "Restore Kit" aFe P/N: 90-50001 blue oil aerosol, or aFe P/N: 90-50501 blue squeeze bottle oil on Filter Replacement P/N 24-40035 Black w/Blue media. Pro Guard 7 Layer air filter replacement P/N 72-40035 (yellow w/gold media) **Pro Dry S™** P/N 21-40035 (black w/white media) **Pro Dry S™** cleaning: see cleaning instruction sheet 06-00074