

THE INFORMATION CONTAINED IN THIS DRAWING IS THE SOLE PROPERTY OF SYNERGY MFG. ANY REPRODUCTION IN PART OR WHOLE WITHOUT THE WRITTEN PERMISSION OF SYNERGY MFG IS PROHIBITED.

Revisions			
Rev.	Description	Date	Approved
A	Initial Release Per ECO 20-092	1/2/20	KB



Dodge Heavy Duty Front Track Bar

Installation Instructions

Applications:
 2003-2013 Dodge 2500
 2003-2012 Dodge 3500

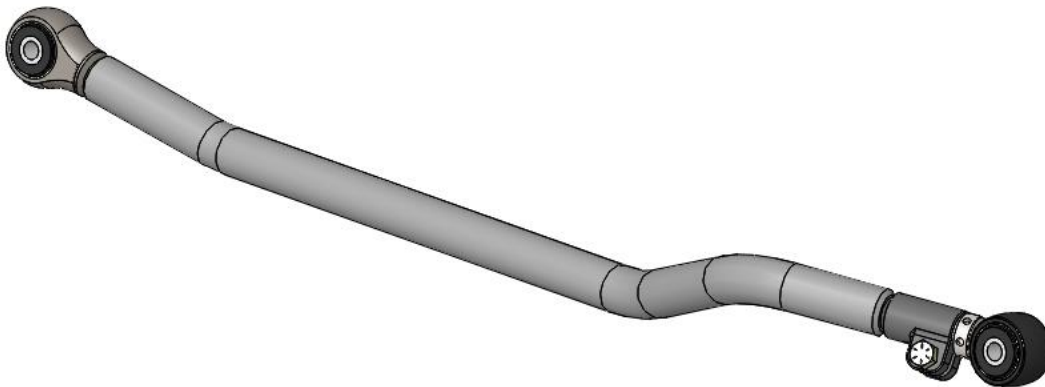

TITLE:
**DODGE HD FRONT TRACK BAR,
 03-13 2500, 03-12 3500 INSTALLATION
 INSTRUCTIONS**

SIZE	DWG NO:	REV
A	8550-11-INST	A
	SCALE: N/A	PAGE 1 OF 8



**DODGE HD FRONT TRACK BAR, 03-13 2500, 03-12 3500
INSTALLATION INSTRUCTIONS**

Thank you for purchasing the best aftermarket products available for your vehicle. We strongly feel that the parts you are about to install should meet or exceed your expectations for performance. Proper assembly is critical to the performance of these components and the vehicle as a whole. Please take the time to carefully read these instructions and familiarize yourself with the installation procedure before working on your vehicle. If you have any questions PLEASE contact Synergy Manufacturing BEFORE beginning installation. Thanks again for supporting Synergy – enjoy the performance benefits of the best aftermarket products available for your vehicle!

Synergy Manufacturing
Phone: (805) 242-0397
Email: support@synergymfg.com

Modifying or otherwise altering vehicle components may cause the vehicle to handle differently than originally designed. It is the driver’s responsibility to familiarize themselves with the performance and handling characteristics of the modified vehicle. Vehicles with larger diameter than stock tires must be driven carefully and cannot be expected to perform as stock or meet OEM performance with regard to handling, braking or crash performance. Ensure all replacement components are compatible with vehicle capacities so as not to overload components, especially tires. It is up to the individual to ensure that the vehicle and all components are compatible with the intended vehicle use, including load ratings, road conditions, and driver abilities. Thorough and frequent vehicle inspections are recommended to ensure a safe and reliable state of readiness, especially after off-highway use.

PARTS LIST

8550-11 Ram HD Front Track Bar		
QTY	Part Number	Description
1	855011-PC	Ram HD Front Track Bar, 03-13 2500, 03-12 3500
1	4812-01	Ram Track Bar Angled Housing DDB Joint
1	3622-07-14L-PL	Threaded Adjuster Sleeve
1	4327-01	Track Bar Bushing, Ram 2013+
1	N/A	Hex Head Bolt, UNF 1/2-20 X 1.75
1	N/A	Top Lock Nut, UNF 1/2-20, Zinc Plate
2	422402-01	OPTIONAL INNER SLEEVE FOR 16MM MOUNTING BOLT



GENERAL NOTES

- These instructions are also available on our website; www.synergymfg.com. Check the website before you begin for any updated instructions and additional photos for your reference.
- The installation of this adjustable track bar will allow you to correctly align the front axle after a suspension lift is installed.
- The track bar features a double adjuster assembly which allows you to adjust the length of the track bar without removing either end of the track bar from the vehicle.
- This track bar fits stock height trucks up to 6.0" of lift. NOTE: on a 6.0" lifted truck, the axle will need to be slightly offset from center to prevent interference with the coil / lower coil bucket and track bar bracket on the driver side.
- Replacement bushings are available from Synergy MFG, part number 4327-01.
- The track bar comes pre-assembled with bushing sleeves intended for 14mm bolts.
 - 2003-2009 trucks come with 14mm mounting hardware.
 - 2010-2013 trucks come with 16mm mounting hardware and will need the included 422402-01 inner bushing sleeves installed.
 - Check your stock hardware as some 03-09 trucks may use 16mm bolts at the axle side. Make sure the inner bushing sleeves you use properly fit your hardware.

TOOLS REQUIRED

- 18 or 21mm and 3/4 inch sockets and wrenches
- 1/4" Punch
- Torque Wrench
- Tape measure and straight edge
- Basic hand tools

ESTIMATED INSTALLATION TIME

1 Hour

INSTALLATION

1. Make sure the vehicle is parked on a flat, level surface. Ensure the vehicle is in park or in gear with the parking brake set.
2. It is easiest to remove the track bar with the weight of the vehicle on the suspension, however, it can be difficult to remove the axle side bolt because the steering drag link and tie rod gets in the way. Lifting the front of the truck on a lift or turning the wheels to the pass side as in **Figure 1.**, can help.



Figure 1. Wheels Turned to the Passenger Side.

3. Use an 18 or 21mm socket and ratchet (or impact) to loosen and remove the axle side track bar bolt. Make sure not to lose the flag nut that secures the bolt on the back side of the bracket. Save the stock hardware as it will be re-used. See **Figure 2.**



Figure 2. Unbolting the Axle Side of the Front Track Bar

4. Use the same 18 or 21mm socket and ratchet to remove the frame side track bar bolt. Make sure to support the track bar as you remove the bolt so it does not fall out of the mount. Completely remove the front track bar from the truck. Save the stock hardware as it will be re-used. See **Figure 3**.



Figure 3. Unbolting the Frame Side of the Front Track Bar

5. Install the new Synergy Dodge HD Front Track Bar. Install the non-adjustable side of the track bar into the axle bracket with the bend on that side facing down (the pinch bolt on the frame side will be facing down). Partially install the track bar bolt. It is easiest to thread the track bar flag nut on if the track bar bolt is not fully seated. Hold the flag nut by the flag and rotate the track bar bolt into the mount and nut. Once the nut has started on the bolt continue to rotate the bolt in. See **Figure 4**.



Figure 4. Installing the Axle End Bolt

6. Push the frame side angled forging up into the frame side track bar mount making sure the angled forging is oriented correctly to easily slide into the frame side bracket. It may need to be spun 180 degrees to fit correctly but do not thread the angled forging out too far. Once in place, adjust the track bar length by spinning the adjuster sleeve until the track bar bushing bolt hole and the frame mount bolt holes line up. Make sure the length of the bar is adjusted by turning the adjuster sleeve and not just spinning the bushing end. There should be equal thread showing on the black forging and the silver adjuster sleeve. If the bar cannot be adjusted to make the bolt holes line up, a ratchet strap between the frame and opposing side on the axle can be used to pull the body over in order to get the bolts to line up. When the bolt holes are lined up, install the factory hardware through the frame side bracket and track bar. See **Figures 6 and 7**.



Figure 6. Installing the Frame Side Bolt

7. Torque the track bar bolts to OEM specifications, see **Figures 8 and 9**:
 - Axle Side bolt and nut: 14mm-200 lb-ft, 16mm-221 lb-ft
 - Frame side bolt and nut: 14mm-200 lb-ft, 16mm 221 lb-ft

8. With the vehicle on the ground at ride height, use the double adjuster assembly to center the axle under the body of the vehicle. You can measure from the frame to the tire on each side, or use a straight edge on the outside of the tires to measure to the fenders on each side in order to get the axle centered. See **Figure 10**. Make sure the adjuster sleeve end is adjusted by turning the adjuster sleeve and not the bushing end or track bar itself. Turning the adjuster clockwise shortens the bar, moving the axle towards the driver side of the vehicle. We recommend rotating the sleeve until one of the slots in the sleeve lines up with the slot in the track bar. Do not exceed 1.75" from the track bar end to the end of the threads on the shank of the angled DDB forging! See **Figure 11**. Use a 1/4" punch, rod, drill bit, or even an allen wrench inserted into the holes in the adjuster sleeve to turn it. See **Figure 12**.



Figure 10. Measuring Axle Side to Side



Figure 11. Max Angled DDB Forging Stick Out



Figure 12. Turning the Adjuster Sleeve.

9. Install the 1/2” pinch bolt through the hole in the forging of the track bar, with the bolt head towards the front of the vehicle, the nut towards the rear. With a 3/4” socket and wrench, tighten the pinch bolt to 90 lb-ft. Check to make sure the pinch bolt has adequately clamped the double adjuster assembly and there is no movement when trying to rotate the adjuster sleeve. See **Figure 13**.



Figure 13. Tightening Pinch Bolt.

10. Re-check bolt torques after the first 100 miles and again after each off-road trip.



Figure 14. Completed Installation

Installation is Complete

Table 1. Ram HD Bolt Torques

Bolted Joint Location	Wrench Size	Torque
Axle Side Track Bar Bolt 14mm	18mm	200 lb-ft
Axle Side Track Bar Bolt 16mm	21mm	221 lb-ft
Frame Side Track Bar Bolt 14mm	18mm	200 lb-ft
Frame Side Track Bar Bolt 16mm	21mm	221 lb-ft
Adjuster Pinch Bolt	3/4”	90 lb-ft