



XDP Cummins CAT Filter Adapter  
Item Number: XD232  
2004.5-2007 Dodge Cummins

**PACKING LIST:**

- 1 – CAT Fuel Filter 1R-0705
- 1 – XDP Filter Adapter
- 1 – Mounting Bracket
- 1 – Support Bracket
- 8 – Banjo Seals
- 2 – 3/8" Hex Bolts and Lock Washers
- 2 – 1/4" Allen Bolts and Lock Washers
- 1 – M6 Button Bolt, Lock Washer and Lock Nut
- 1 – M8 Button Bolt, Lock Washer and Lock Nut
- 1 – M8 Hex Flanged Bolt
- 1 – M8 Hex Bolt



Before removing any parts from your truck, please read over the install steps and verify you have everything necessary to install your XDP Cummins CAT Filter Adapter.



Ensure that the vehicle has not been in use and that the engine is cool to the touch. Always wear eye protection when working on any vehicle.

**\*Attention 2004.5 owners:** Because the CAT Filter Adapter removes the factory fuel filter housing, it will not work on early model trucks that have the lift pump mounted to the fuel filter housing.

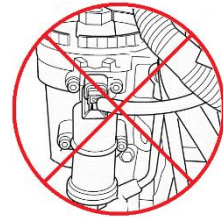

**Step 1:** Disconnect your batteries.

**Step 2:** Remove the driver side front fender liner to gain best access to the factory fuel filter housing.

**Step 3:** Unscrew the fuel filter cap from the top of the fuel filter housing.

**Step 4:** Locate the drain valve and drain hose on the left side of the fuel filter housing.

**Step 5:** Place a small container under the filter drain tube and drain the fuel from the housing.

**Step 6:** Disconnect the two sensors from the housing.

**Step 7:** Remove the 4 fuel lines connected to the housing along with the support brackets.

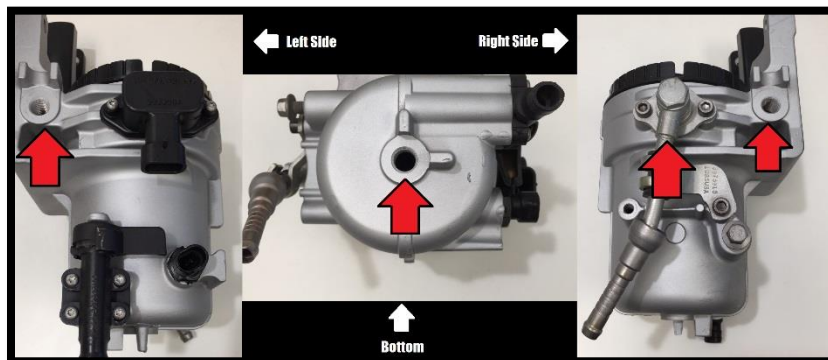

**Step 8:** Remove the bolts securing the fuel filter housing to the engine and remove the housing.

**Step 9:** Install the supplied mounting bracket to the XDP Filter Adapter using the supplied lock washers and bolts. **(Image A)**

**Step 10:** Loosely install the supplied support bracket to the right side of the XDP Filter Adapter using the two ¼" Allen Bolts and Lock Washers. **(Image B)**

**Step 11:** Install the XDP Filter Adapter onto the side of the engine using the supplied hardware. The longer M8 Hex Bolt will secure the bottom of the mounting bracket and the M8 Hex Flanged Bolt will support the top left side of the bracket. (The top right of the bracket will be supported with the factory hardware.)

**Step 12:** Using the supplied Banjo Seals, reinstall the two banjo bolts that connect the two hard lines to the back sides of the filter adapter. (Make sure not to stack the seals with the originals as this will cause a fuel leak.)

**Step 13:** The supply line banjo fitting will connect to the forward right side of the filter adapter marked "IN". Using the supplied Banjo Seals, reinstall the banjo bolt to connect the supply line to fuel filter adapter.

**Step 14:** The support bracket will mount to the left side of the support tab using the smaller button head Allen Bolt and lock nut. **(Image C)**

**Step 15:** The last banjo fitting will have to be turned upward and connected to the out port onto the filter block. This was the fitting that was originally at the bottom of the fuel filter housing. **(Image D)**

**Step 16:** Tighten all mounting and support bracket hardware.

**Step 17:** Tighten all banjo bolts to 35 ft lbs.

**Step 18:** Ensure CAT filter is tightly secured on the filter adapter with some type of assembly lubricant on the O-ring.

**Step 19:** Reconnect your batteries and start the engine to check for any leaks.

**Step 20:** Reinstall the driver side front fender liner.

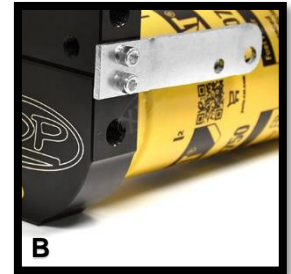

1-888-DIESEL4 – 1-888-343-7354

WWW.XDP.COM