

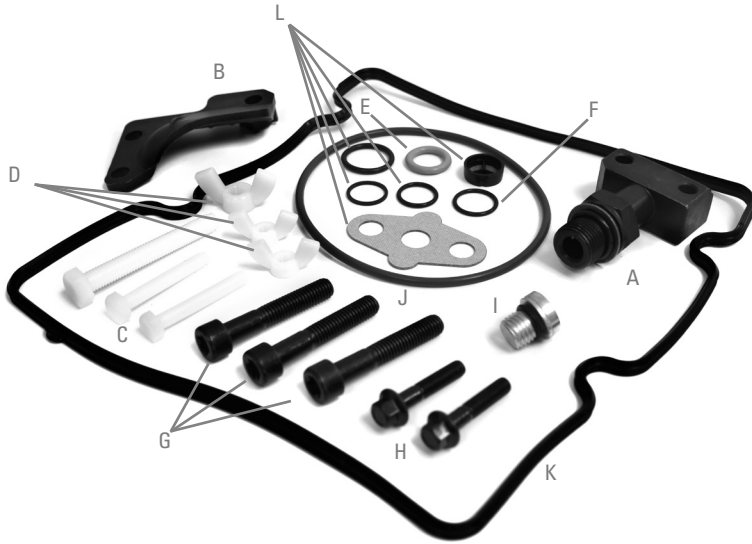

PART NO. XD269

XDP STC HPOP FITTING UPDATE KIT

INSTALLATION MANUAL



CODE	DESCRIPTION	QTY
A	Updated STC Fitting	1
B	Jig	1
C	Nylon Bolts	3
D	Nylon Wing Nuts	3
E	Seal HPOP Feed O-Ring	1
F	Seal Branch Tube O-Ring	1
G	HPOP Mounting Bolts T-45 Torx Head	3
H	STC Discharge Mounting Bolts 8Mm Head	2
I	HPOP Port Plug	1
J	HPOP Cover O-Ring	1
K	HPOP Cover Mounting Gasket	1
L	IPR Reseal Kit	1



BEFORE REMOVING ANY PARTS FROM YOUR TRUCK, PLEASE COMPARE THE ITEMS YOU HAVE RECEIVED WITH THE PACKING LIST PROVIDED TO VERIFY THAT YOU HAVE EVERYTHING NECESSARY TO INSTALL YOUR NEW XDP STC HPOP FITTING UPDATE KIT.

1" Open-End Wrench

15/16" Crows Foot Adaptor

3/8" Drive Torque Wrench



BEFORE YOU BEGIN! Ensure that the vehicle has not been in use and that the engine is cool to the touch. Always wear eye protection when working on any vehicle.

- 1 Unbox the XDP STC fitting update kit and lay out onto bench or work area. (Figure 1)



FIGURE 1

- 2 Verify all kit components match the packing list prior to installation.

- 3** Place the high-pressure oil pump in a suitable vise. (Figure 2)

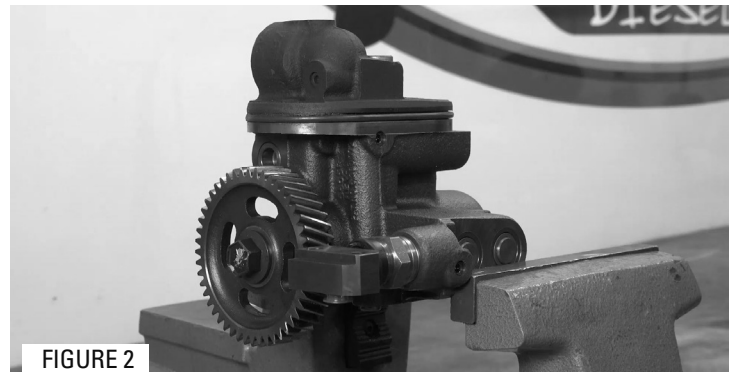

- 4** Remove the existing high-pressure oil branch tube adapter and jam nut fitting from the high-pressure oil pump using a 1" open end wrench. (Figure 3)



- 5** Discard the previously removed high-pressure oil branch tube adapter.

- 6** Locate the new XDP high-pressure oil branch tube adapter and apply clean engine oil to the threads and jam nut. (Figure 4)

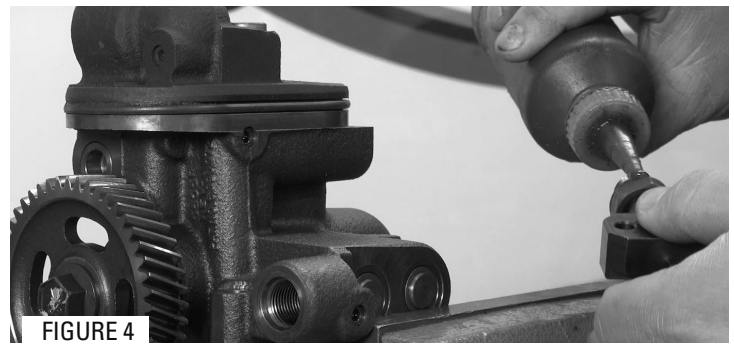

- 7** Install the high-pressure oil branch tube adapter into the high-pressure oil pump by threading it five complete turns to set the proper depth and orientation. If the branch tube adapter cannot be threaded on completely, back the jam nut off one full turn to complete threading the high-pressure oil branch tube adapter into the high-pressure oil pump. (Figure 5)

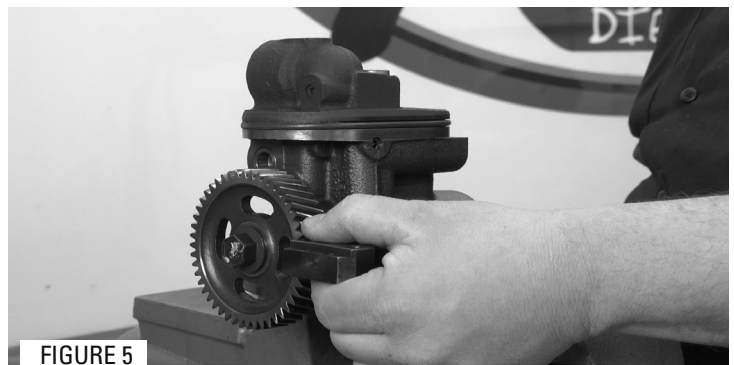

- 8** Install the supplied plastic bolts and wing nuts from kit to align and position the jam nut fitting. Tighten plastic bolts and wing nuts by hand. NOTE: This tool ensures the high-pressure oil branch tube adapter is installed at the correct depth to prevent high-pressure oil leaks.(Figure 6)

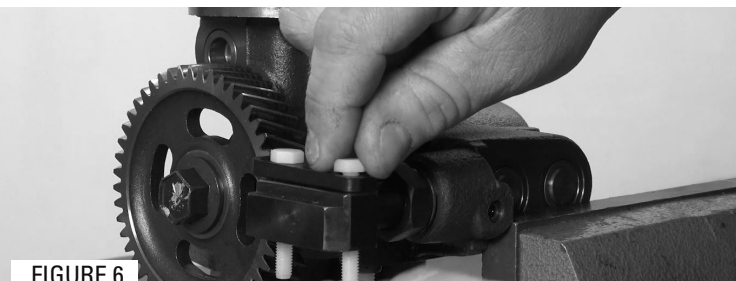

FIGURE 6

- 9** Tighten the jam nut with a 15/16" crowfoot adapter and torque wrench. Tighten to 66 Nm (49 lb-ft). (Figure 7)

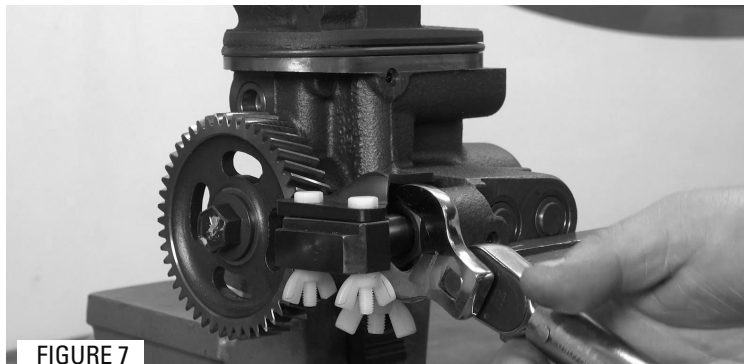

FIGURE 7

- 10** Remove and discard the plastic bolts, wing nuts and holding tool. (Figure 8)

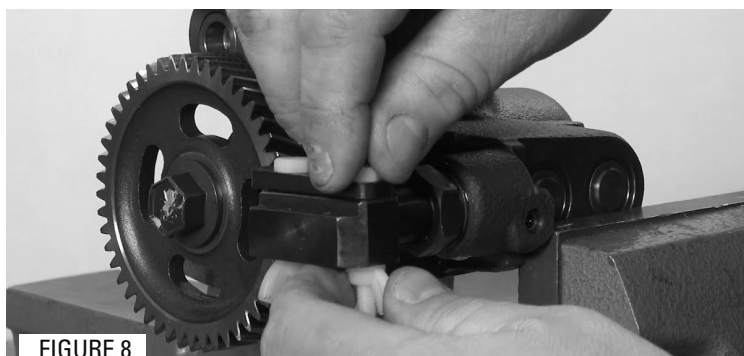

FIGURE 8

- 11** The XDP STC HPOP fitting update is now properly installed and can be removed from vise. Prior to installing high-pressure oil pump back into vehicle, match the new O-rings in the provided kit with the O-rings removed. Several O-rings are similar in size but will not seal if used in the wrong location. (Figure 9)

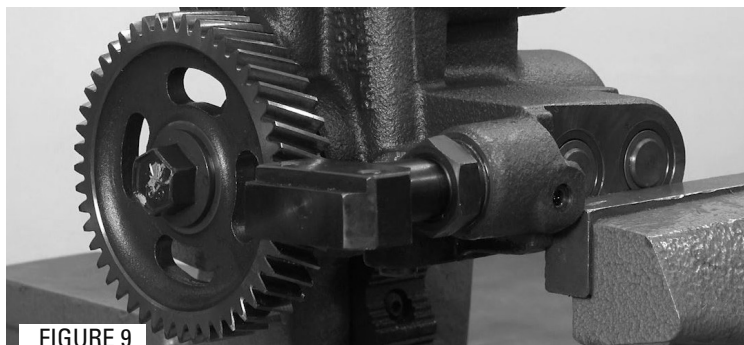

FIGURE 9

